

White paper

Fujitsu PalmSecure ID Access

Fujitsu PalmSecure ID Access (PSN 900) is a biometric physical access control (PAC) system with additional time and attendance (T&A) software. The solution is based on a PAC device that supports very secure, ergonomic and convenient multi-factor and single-factor authentication. Fujitsu PalmSecure ID Access is suited for various access control implementations and can be integrated into existing infrastructure.

Content

Fujitsu PalmSecure	1
Fujitsu PalmSecure ID Access - The digital handshake	2
Fujitsu PalmSecure ID Access - Functions and highlights	3
Physical Access Control PSN900	3
Network Management System	3
Conclusion	3



Fujitsu PalmSecure - Security always at hand

PalmSecure offers simple and reliable personal identification

The only reliable forms of personal authentication are based on biometric characteristics, and the veins in the palm of the human hand are especially well-suited for biometric authentication. Palm vein patterns are unique for each person – even twins have different patterns. Fujitsu PalmSecure is the most precise, versatile and convenient biometric technology of its kind on the market:

- **Maximum security:** Veins are concealed under the skin, and the identification is literally “live” and forgery-proof, because the process functions only when hemoglobin is flowing through a person’s veins.
- **Maximum accuracy:** With a false acceptance rate of less than 0.00008 percent, Fujitsu PalmSecure is the most precise authentication system in the world.
- **Maximum performance:** The registration process is complete in just ten seconds, and identification is complete in just one or two seconds – faster than any password solution.
- **Highly accepted by users:** The technology is touch-free and thus completely hygienic. The hand is simply held over the sensor – that makes PalmSecure easy to use.
- **Quite versatile:** The technology can be used for site access control, time recording and mobile applications, in the web and at the workplace.
- **Used worldwide by airports, banks, business enterprises, data centers, governments, in the healthcare sector and in the retail sector.**

Fujitsu PalmSecure has an additional advantage: It can be combined with other authentication methods. Fujitsu **PalmSecure ID Access** offers a type of two-factor authentication that combines the unique PalmSecure technology with RFID cards.



Fujitsu PalmSecure ID Access - The digital handshake

Fujitsu PalmSecure ID Access is designed to be used as physical access control system. It is used in a wide range of application e.g. to protect doors within company buildings or data centers. PalmSecure ID Access can be expanded by optional time and attendance (T&A) software.

To fit customer needs Fujitsu ID Access combines the security of Fujitsu’s PalmSecure technology with optional RFID smart cards for physical access control. Such a smart card can be used as second factor for authentication in the ID Access device (1:1 matching). The ID Access device can also handle a 1:many matching (<100 user). For 1:N matching on a server optional software (PalmPass One) is available.

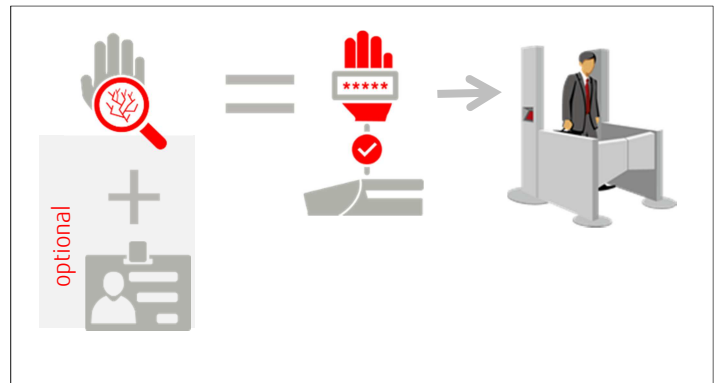

Fujitsu PalmSecure ID Access prevents misuse caused by card theft or the disclosure of keys or PIN. Unauthorized access to buildings or working time deception can be prevented.

Fujitsu offers a complete solution platform comprising hardware, software and services for optimizing existing PAC infrastructure

- The hardware, Fujitsu ID Access PSN900 includes a 5.0” touch screen and supports Mifare or HID card reader as well as the PalmSecure sensor, too. The memory capacity of 4 GB is expandable and allows to match ID on the device.
- Network Management System (NMS) is the managing software which comes with PalmSecure ID Access PSN900. It handles:
 - User management
 - Device management
 - Data management
 - Attendance management
- Integration into existing PAC infrastructure using the Wiegand 26/34 interface

Fujitsu PalmSecure ID Access - Functions and highlights

Physical Access Control PSN900

PalmSecure ID Access using Fujitsu PalmSecure vein scanning technology ensures high recognition rate, full coverage, fast recognition and is contactless. The system is highly scalable. It is designed to scale thousands of users with multiple types of authentication devices for additional two-way authentication.

PalmSecure ID Access is easy to adapt in any control panel system.

Authentication method

PalmSecure ID Access enables three types of authentication*

- 1:1 verification with smartcard
- 1:N authentication on the device
- 1:N authentication on a server (requires additional server hardware and PalmPass One software)

1:1 verification

User needs to enroll palm vein template which is stored on a RFID card or RFID token. User needs to carry the card with himself all the time. Capacity of such a method: up to 40.000 users. Fast authentication speed.

1:N authentication on the device

Once a user is enrolled with his palm vein template it is stored locally on the device. The user doesn't need to carry a card or any other second factor for authentication with him. Capacity is up to 100 IDs. Authentication speed is reduced in case more IDs are stored.

1:N authentication on the device by group code

Users are enrolled with their palm vein template and a specific group code. User needs to remember the group code and specify for authentication (menu based). Capacity is up to 300 IDs and quicker than 1:N without group ID.

1:N authentication on a server

Requires additional PalmPass One software to manage IDs and perform user administration on a server. Capacity up to 1000 IDs (I format) or up to 10.000 IDs (I33 format). As authentication speed depends on server performance – this usually is the fastest method for authenticating large amount of users.

Fujitsu PalmSecure ID Access physical access control can be configured for a variety of customer requirements. Fujitsu offers optional consulting services for this purposes.

*Special privacy law of country and/ or segment should be taken into account.

Model PAC system with PalmSecure ID Access

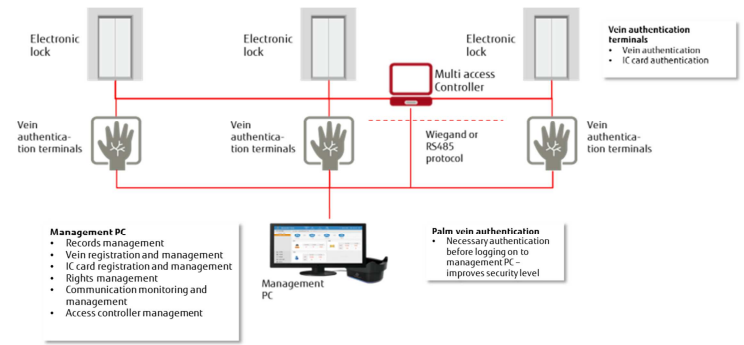

Network Management System (NMS)

Main function of the Network Management Software is to manage and monitor user, device, data and attendance. In addition it allows to create all kinds of reports.

Please be aware to install PalmPassOne if you need to manage your Fujitsu PalmSecure ID Access solution centrally. Network Management System does only handle local template matching.

Conclusion

Fujitsu PalmSecure ID Access grants maximum security due to unique precision of Fujitsu PalmSecure technology. It achieves highest user convenience by intuitive, contactless and hygienic usage, designed to support highest data privacy protection.



Fujitsu PalmSecure ID Access. Reliable verification of personal identities

Contact

FUJITSU Technology Solutions GmbH
Mies-van-der-Rohe-Str.8; 80807 Munich
Germany
Website: www.fujitsu.com/PalmSecure

© 2017 FUJITSU Technology Solutions GmbH. Fujitsu, the Fujitsu logo, are trademarks or registered trademarks of Fujitsu Limited in Japan and other countries. Other company, product and service names may be trademarks or registered trademarks of their respective owners. Technical data subject to modification and delivery subject to availability. Any liability that the data and illustrations are complete, actual or correct is excluded. Designations may be trademarks and/or copyrights of the respective manufacturer, the use of which by third parties for their own purposes may infringe the rights of such owner.